



CODEMARK™
Building Confidence

Sunhood and Blade 12 Point Installation Guide

Refer to NRG Specification Guide - www.nrggreenboard.com



Environmentally Responsible. Energy Efficient. Building Systems.



STEP DETERMINE NRG SUNHOOD OR NRG BLADE**1** ...positioning to exterior wall/ window/ door.**IMPORTANT: TO BE INSTALLED BY QUALIFIED TRADESMEN****STEP** DETERMINE EXTERIOR WALL STRUCTURE & SUBSTRATE:**2** ...Timber/steel frame, masonry block/brick, tilt panel. Select correct galvanised mechanical fixings for exterior wall structure/substrate (see table below).**GALVANISED BRACKET MECHANICAL FIXING TABLE**

SUBSTRATE	GALV 12MM Dia	MIN LENGTH	EXAMPLE
Masonry	Dyna Bolt	50mm	Tilt Panel/ Block
Masonry	Coach Screw/Plug	65mm	Brick Veneer
Timber Frame	Coach Screw	65mm	Cladding Substrate
Steel Frame	Purlin Bolt	30mm	Cladding Substrate

STEP ENSURE LEVEL LINE SET OUT:**2.1** ...to the underside of the NRG Sunhood, desired height. Locate and fix galvanised mechanical brackets to wall structure @ 600mm centres maximum. (NOTE: Polyurethane seal back plate of bracket & bolt penetrations to wall structure/ substrate to prevent water egress).**STEP** SLIDE NRG SUNHOOD/BLADE:**7** ...onto brackets and push back until the rear back face of the Sunhood/ Blade compresses tight back to wall structure. Check for level/ plumb into final position and temporarily prop support for 24 hours.**STEP** TRANSFER BRACKET CENTRE DIMENSION:**3** ...to the rear back edge of the NRG Sunhood/ Blade. Position height co-ordinate of axis (for bracket hole) approximately 50mm up from the base of Sunhood or centre- line of blade.**STEP** ADHERE P.V.C. UV STABILISED EXTERNAL BEADS:**8** to all external corners and use expansion bead to underside front edge to form a drip groove.**STEP** USING A 30mm DRILL BIT:**4** ...bore this oversized hole to the required depth to each corresponding bracket. Thoroughly remove all loose e.p.s bead debris.**STEP** PRIMARY & SECONDARY POLYURETHANE SEAL:**9** (prior to render) ...Sunhood/Blade attachment at wall intersection. Secondary over seal post render (prior to waterproofing process)**STEP** DRY FIT NRG SUNHOOD/BLADE:**5** ...onto structural galvanised bolted brackets to wall structure. Ensure Sunhood/Blade fits correctly (level & plumb) at this stage.**STEP** NRG RENDER ACRYLIC SYSTEM:**10** ...1st coat and 2nd Polymer Modified render/ fibreglass mesh. Top coat acrylic texture. NOTE: 48 HOUR CURE TIME ('V' disk join @ wall top internal for Polyurethane Secondary over seal).**STEP** REMOVE NRG SUNHOOD/BLADE:**6** ...Place face (front edge) down onto ground level. Using expandable trigger foam, inject (saturate) all 30mm bored holes ensuring liquid foam has encased entire sleeve hole from its base up to the outer edge. Also generously trigger foam the back edge face that is to secure to wall structure.**STEP** WATERPROOF APPLICATION:**11** ...x 2 coats over top face, (turn up 100mm onto wall face) front edge and bottom edge return to drip groove. (NOTE: Using a polyurethane UV stabilised exterior membrane)**STEP** APPLIED FINISHES: NOTE: To exterior**12** specification for rendered surfaces.



Sunhoods & Blades

Design Simplicity-Energy Efficient-Building Systems



Combining Sunhoods with NRG Greenboard™ Wall Cladding System

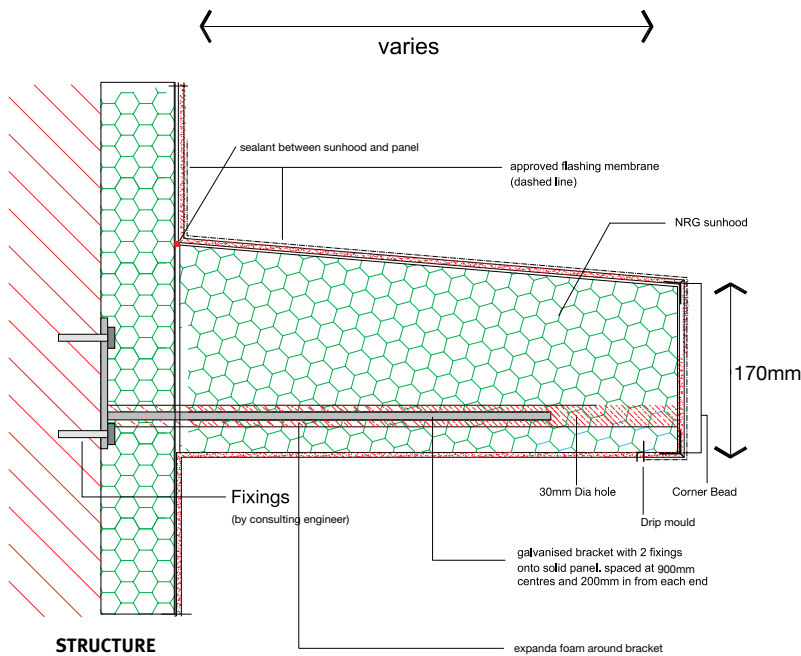

STRUCTURE

- Timber
- Steel
- Masonary
- Other

NOTE: Critical to waterproof sunhoods before painting.

NRG Sunhoods and Blades are design for Aesthetic and Energy Efficiency Purposes and are engineered for wind loading, not as a trafficable area (i.e. platform/support area).

Description (Standard length 2500mm)	Width (mm)	Front Height (mm)	Rear Height (mm)	Bracket Size
Sunhood -Window Awning	300mm	170mm	210mm	200mm
Sunhood -Window Awning	450mm	170mm	210mm	300mm
Sunhood -Window Awning	600mm	170mm	210mm	450mm
Sunhood -Window Awning	750mm	170mm	210mm	600mm
Sunhood -Window Awning	900mm	170mm	210mm	750mm
Sunhood -Window Awning	1200mm	170mm	210mm	1050mm
Blades	As Above	170mm	170mm	As Above

Benefits

- Design Simplicity
- Lightweight Construction
- Speed of Installation
- No more costly fabrication or forming-up
- Suitable for Residential, Commercial, Industrial and Refurbishment
- Providing a 'polymer modified, fully reinforced render system'.
- Extensive choice of textures & colour finishes. (applied by licensed trades persons on site)
- Assist in Compliance* with BCA 2006 3.12.2.2 -Volume Two-Shading

Australian Building Codes Board -3.12.2.2 Shading -Page 542

Where shading is required to comply with 3.12.2.1, it must—

- a) be provided by an external permanent projection, such as a verandah, balcony, fixed canopy, eaves, shading hood which
 - i) extends horizontally on both sides of the glazing....
 - ii) provide the equivalent shading to (i).....
- b) be provided by an external shading device, which
 - i) is capable of restricting at least 80% of the summer solar radiation; &
 - ii) if adjustable, is readily operated.

Explanatory information:

- 1) Shading devices can include fixed louvers, However, such devices need to be designed for the climate and latitude to ensure that summer sun penetration is restricted, while winter sun access is achieved.
- 2) Gutters can only be considered as providing shading if attached.
- 3) Shading devices can be either attached or located . . . may be considered to provide shading to glazing if it complies with 3.12.2.2(b).

Extracts from the Building Code of Australia have been supplied with the permission of the Australian Building Codes Board -www.abcb.gov.au

* Subject to site orientation of structure by qualified design professional and engineers specifications, together with the limitations governed by physical dimensions due to manufacturing processes

** NRG Energy Building Systems reserves the right to alter dimensions of Sunhood and Blades. *** Special Sizes' within the limit of widths shown may be ordered –price on application.